

# THE PRESERVE AT CANYON RIDGE



All drawings and measurements are for marketing purposes and are approximate.

Due to COVID 19: Because of supply chain delays or lack of material availability, materials and selections might be substituted with equal quality and pricing by the builder.

## MICHEL 1-RANCH-1899 SQ FT

- Convenient One-Level Living
- 3 Bedrooms, 2 Baths
- Hardwoods Throughout Main Living Area
- Master Bedroom Has Very Large Walk-In Closet
- Abundant Windows In Dining/Morning Room
- Kitchen Has Large Island Counter & Generous Walk-In Pantry
- Open Floor Plan
- Fireplace
- Entry From Garage Includes "Mud Room"
- Covered Back Porch
- 2-Car Garage (3-Car Garage Optional Depending on Lot Width)

### OPTIONAL/UPGRADES

- Add Shake-Style Siding
- Add Additional Stone to Front Elevation

[ThePreserveAtCanyonRidge.com](http://ThePreserveAtCanyonRidge.com)

770-776-8665

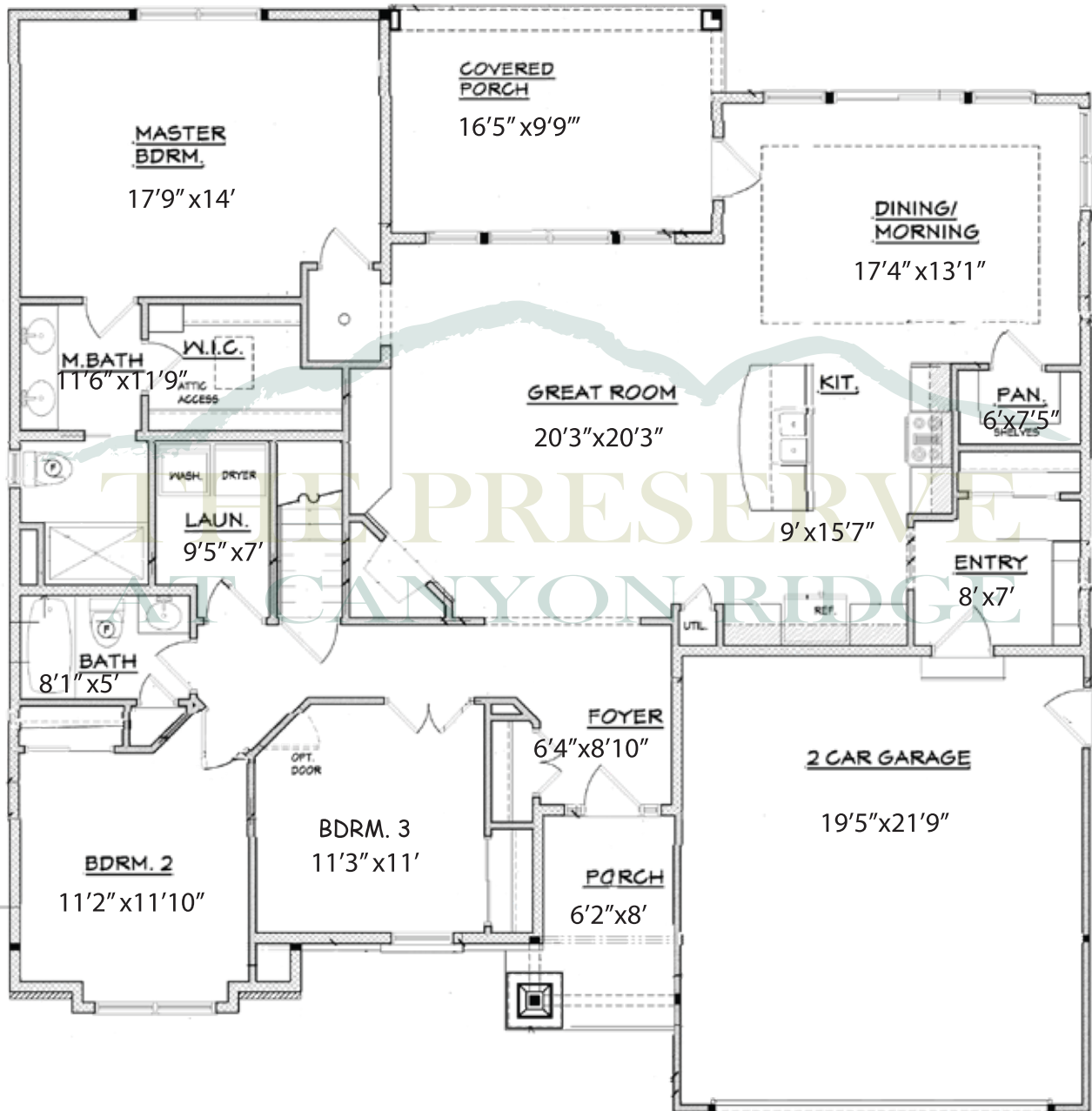

All drawings and measurements are for marketing purposes and are approximate.

Due to COVID 19: Because of supply chain delays or lack of material availability, materials and selections might be substituted with equal quality and pricing by the builder.