



704.859.1512

Welcome to Barnhardt Meadows in China Grove, NC

Barnhardt Meadows is a new neighborhood subdivision featuring an open country setting with one or two story homes that can be customized to your preferences.

Three phases in the plans and we are currently in the process of building Phase One.

This gem is centrally located with a close proximity to Charlotte (30 miles), Winston-Salem (50 miles), Interstate 85 (less than 10 miles) and Interstate 77 & Mooresville (20 miles).

DIRECTIONS: Barnhardt Meadows is located on Dorothy Drive off of Patterson Rd., midway between Weaver Rd., to the north and Brown Rd. to the south. Major routes such as Route 150, Route 152 and Interstate 85 can be used to access these routes.

Whether your interests include hiking, boating, golf, wineries/breweries and festivals, we have something to appeal to everyone. Need a weekend getaway? The mountains are less than two hours and the beach less than a four hour drive.

Stop in and see what the best of North Carolina has to offer!

LOTS FOR SALE

HOMES FOR SALE

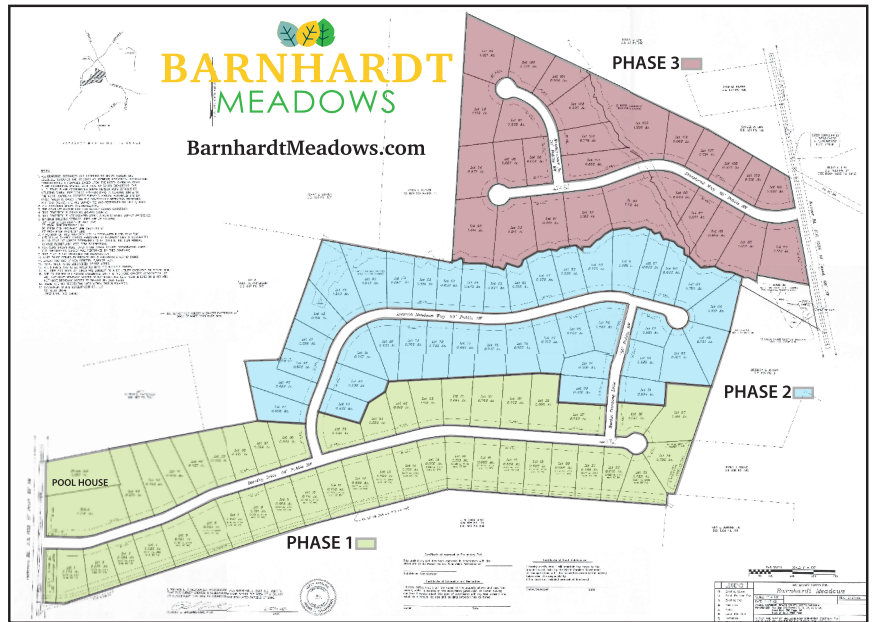

BarnhardtMeadows.com